

# Shock-Crete

The Ultimate  
Thermal Shock Resistant Flooring System



**Dudick** inc.

# The Dudick Difference

*Why is the service from Dudick superior to that of other manufacturers?*

**It's our highly-trained field technicians.**

Dudick technicians are former applicators with extensive front-line experience working with our products. They bring their expertise to every job we do, making sure your project is completed to perform at the highest level.



## Our Shock-Crete Product Line

Shock-Crete is a signature product and a real work horse. It's durable, reliable and attractive and built to withstand constant cleaning in harsh environments.

Developed more than two decades ago, Shock-Crete, has been installed in hundreds of plants, manufacturing facilities and other locations nationally and internationally with outstanding results.

When properly installed, the Shock-Crete system delivers on our promise of 100 percent satisfaction guarantee.



\*The LEED® (Leadership in Energy and Environmental Design) Green Building Rating System is the nationally accepted benchmark for the design, construction and operation of high performance green buildings.

*LEED and related logo is a trademark owned by the U.S. Green Building Council and is used by permission.*



## Shock-Crete HD

*Shock-Crete HD is a chemical-resistant, heavy-duty urethane cement specifically designed for temperature extremes ranging from -350°F to +400°F and damp environments, as well as over damp concrete. It is typically applied at 1/4"-3/8" and provides a seamless matte finish with a slight texture.*

*All Shock-Crete systems are formulated using high-quality, anti-microbial additives to inhibit the growth and spread of bacteria and fungus. Shock-Crete helps provide an FDA- and USDA-compliant workplace.*

### Benefits

**Sterile** – Anti-microbial additives aid in a clean, sterile environment for processing facilities.

**Environmental** – Shock-Crete HD is low in VOCs for added LEED credits.

**Cleanability** – Will withstand daily wash downs using hot water and steam cleaning.

**Chemical Resistance** – Excellent chemical resistance, including sanitizers, organic and inorganic acids.

**Application** – Easy application, extremely low odor and fast setting for minimum downtime.

**Maintenance** – When properly applied, Shock-Crete HD requires minimal maintenance. Standard cleaning and sanitizing compounds can be used on Shock-Crete floors.

### Physical Properties

Coefficient of Thermal Expansion	..... 1.1 x 10 <sup>-5</sup>	ASTM C-531
Compressive Strength	..... 7,300 PSI	ASTM C-579
Modulus of Elasticity	..... 1.7 x 10 <sup>5</sup> PSI	ASTM C-579
Tensile Strength	..... 825 PSI	ASTM C-307
Flexural Strength	..... 1,800 PSI	ASTM C-580
Taber Abrasion	..... 70 mg.	ASTM D-4060
Tensile Bond Strength	..... Cohesive Failure	ASTM D-4541 of Concrete
Density	..... 130 lb./cu. ft.	
VOC	..... 43 g/l (calculated)	
Slip Coefficient	..... 0.84 dry 0.71 wet	
With Aggregate	..... 1.02 dry 0.83 wet	ASTM C-1028

### Resistant to:

Acetic Acid
Ammonium Hydroxide, 28%
Carbonic
Citric Acid
Corn Starch
Ethanol, 60%
Formaldehyde, 37%
Fructose
Hydrochloric Acid, 37%
Hydrogen Peroxide, 28%
Lactic Acid
Lysol, 5%
Methanol
Peracetic Acid, 70%
Phosphoric Acid
Sodium Carbonate, 20%
Sodium Hydroxide, 50%
Sodium Hypochlorite, 5%

### Color Chips

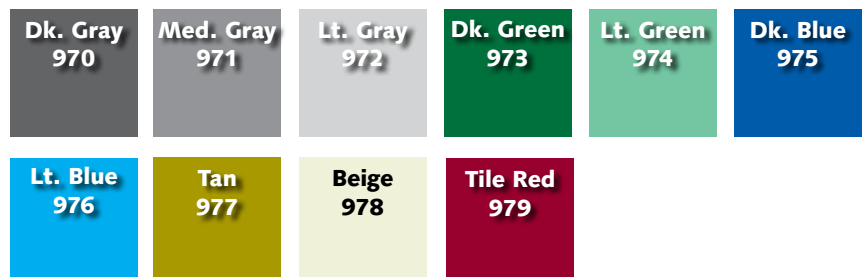



## Shock-Crete SL

*Shock-Crete SL is a chemical-resistant, self-leveling urethane cement with lower temperature parameters than Shock-Crete HD but still suitable in wet environments. It is typically applied at 1/16" - 3/16" and provides a seamless matte finish. Faster and easier application than Shock-Crete HD, yet highly durable. Temperature extremes of 32°F to 180°F.*

*All Shock-Crete Systems are formulated using high-quality, anti-microbial additives to inhibit the growth and spread of bacteria and fungus, giving you a clean workplace.*

### Benefits

**Sterile** – Anti-microbial additives aid in a clean, sterile environment for processing facilities.

**Environmental** – Shock-Crete SL is low in VOCs for added LEED credits.

**Cleanability** – Will withstand daily wash downs using hot water.

**Chemical Resistance** – Excellent chemical resistance to sanitizers, organic and inorganic acids.

**Application** – Can be applied over damp concrete. Easy application and fast setting for minimal downtime.

**Maintenance** – When properly applied, Shock-Crete SL requires minimal maintenance. Standard cleaning and sanitizing compounds can be used on Shock-Crete floors.

### Physical Properties

Coefficient of .....	2.2 x 10 <sup>-5</sup>
Thermal Expansion ASTM C-531	
Compressive Strength ....	6,800 PSI
ASTM C-579	
Modulus of Elasticity .....	2.2 x 10 <sup>11</sup> PSI
ASTM C-579	
Tensile Strength .....	1,050 PSI
ASTM C-307	
Flexural Strength .....	2,600 PSI
ASTM C-580	
Taber Abrasion .....	70 mg.
ASTM D-4060	
Tensile Bond Strength ....	Cohesive Failure
ASTM D-4541	of Concrete
Density .....	125 lb./cu. ft.
VOC .....	43 g/l (calculated)
Slip Coefficient .....	0.80 dry 0.61 wet
ASTM C-1028	

### Resistant to:

Acetic Acid
Ammonium Hydroxide, 28%
Carbonic
Citric Acid
Corn Starch
Ethanol, 60%
Formaldehyde, 37%
Fructose
Hydrochloric Acid, 37%
Hydrogen Peroxide, 28%
Lactic Acid
Lysol, 5%
Methanol
Peracetic Acid, 70%
Phosphoric Acid
Sodium Carbonate, 20%
Sodium Hydroxide, 50%
Sodium Hypochlorite, 5%

### Color Chips

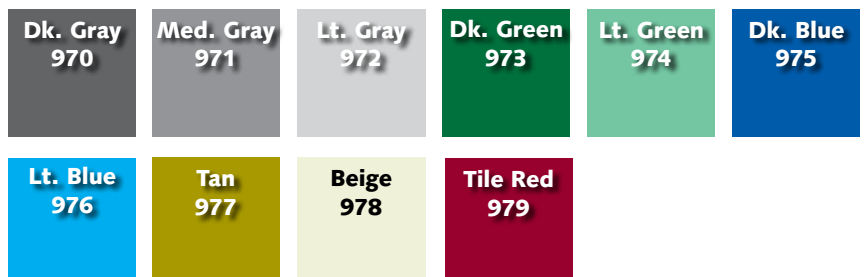



## Steri-Crete SL

*Steri-Crete SL is a decorative version of Shock-Crete SL developed for applications for spills less than 120°F. Steri-Crete SL represents a minor compromise on high concentrations of chemical acids and cleaning compounds. It is typically applied 1/16" – 3/16" and provides a seamless, decorative, flake- or quartz-color appearance.*

*All Shock-Crete systems are formulated using high-quality, anti-microbial additives to inhibit the growth and spread of bacteria and fungus to ensure a clean workplace.*

### Benefits

**Appearance** – Decorative finishes of colored flakes or quartz.

**Sterile** – Anti-microbial additives assist in clean, sterile environments for processing facilities.

**Environmental** – Steri-Crete SL emits low VOCs.

**Cleanability** – Will withstand daily wash downs using hot water less than 120°F.

**Chemical Resistance** – Excellent chemical resistance to sanitizers, organic and inorganic acids.

**Application** – Can be applied over damp concrete. Easy application and fast setting for minimal downtime.

**Maintenance** – When properly applied, Steri-Crete SL requires minimal maintenance. Standard cleaning and sanitizing compounds can be used on Steri-Crete SL floors.

### Physical Properties

Coefficient of .....  $1.1 \times 10^{-5}$   
Thermal Expansion  
ASTM C-531

Compressive Strength .... 7,300 PSI  
ASTM C-579

Modulus of Elasticity .....  $1.7 \times 10^5$  PSI  
ASTM C-579

Tensile Strength ..... 825 PSI  
ASTM C-307

Flexural Strength ..... 1,800 PSI  
ASTM C-580

Taber Abrasion ..... 70 mg.  
ASTM D-4060

Tensile Bond Strength .... Cohesive Failure  
ASTM D-4541 of Concrete

Density ..... 125 lb./cu. ft.

### Resistant to:

Dilute acids and caustics



### Color Chips

#### Flake

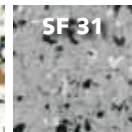
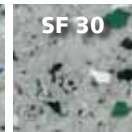
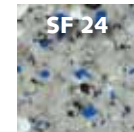

#### Quartz



# Complementary ceiling & wall products for every job

## Primers

### Primer 67

Moisture-tolerant, 100% solids, low VOC epoxy primer.

### Primer 67DTO

Moisture-tolerant, 100% solids, low VOC, low odor epoxy primer for enhancing the adhesion of epoxy-based toppings, coatings and linings to oil contaminated concrete substrates.

## Caulks

### Caulk 139

100% solids, pourable two-component flexible epoxy control and construction joint filler with broad chemical resistance and 50% elongation.

### Caulk 149

100% solids, two-component polysulfide caulk with 500% elongation, readily applied with a trowel.

## Concrete Repair

### C Grout

Fast-setting 100% cementitious grout for economical repairs to spalled floors. Can be coated in eight hours even with moisture sensitive coatings.

### Grout 100

High-performance epoxy grouting material for use in anchoring heavy equipment.

### Scratch Coats

Epoxy and vinyl ester-based "block fillers" to repair small gouges, bug holes and honeycombing prior to coating. Fast setting, economical and compatible with all Dudick floor systems.

## Ceiling & Wall Products

### Steri-Coat P

This novolac epoxy was developed to tackle problems that occur on the surfaces of plant ceilings, walls and tank exteriors. These problems can lead to non-compliant conditions for processing food.

#### Additional benefits include:

- 100% Solids Epoxy
- "0" VOC
- USDA and FDA Compliant
- Longer service life than traditional wall paints
- Exceptional resistance to flaking, chipping and staining
- High durability – long life, easily cleaned
- Chemical and abrasion resistant
- Easy to apply
- Superb stain resistance
- Low installation odor and no hazardous fumes (VOC's)
- Anti-microbial agents reduce bacteria and fungus growth
- UV stable and available in a wide variety of colors, including bright white

### Steri-Glass

Dudick's Steri-Glass reinforced epoxy offers the same benefits as Steri-Coat P for your plant ceilings, walls and tank exteriors.

#### Additional benefits include:

- 100% Solids Epoxy
- "0" VOC
- USDA & FDA Compliant
- Contains a fiberglass reinforcement for increased resistance to impact and thermal shock
- Crack resistant

### Steri-Seal HB

High-build, multi-functional epoxy for wall and ceiling coatings with higher build/thickness than Steri-Coat P.

#### Additional benefits include:

- 100% Solids Epoxy
- "0" VOC
- USDA & FDA Compliant



# Typical Installation Details

# Shock-Crete HD Shock-Crete SL Steri-Crete SL

## Typical Termination of Stainless Channel Drain

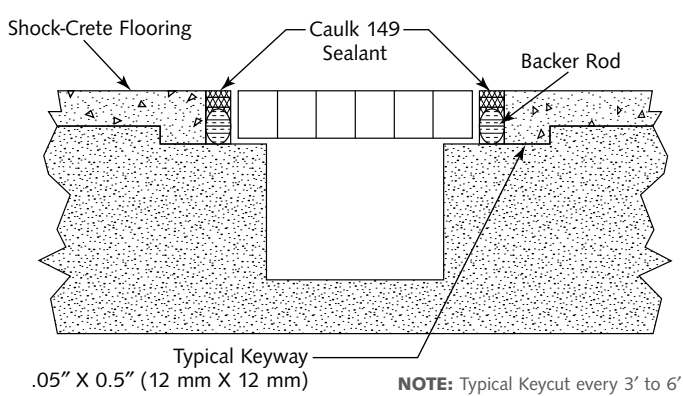

## Carbon Steel Floor Drain Cross Section

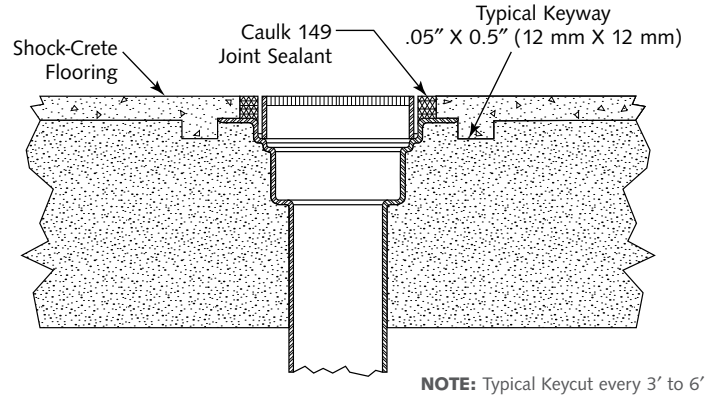

## Typical Feathered Edge Termination

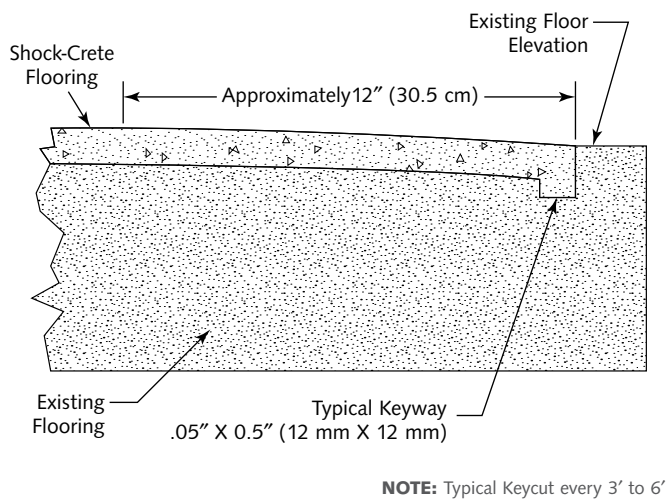

## Bottle Cove to Cove with Expansion Joint at Wall

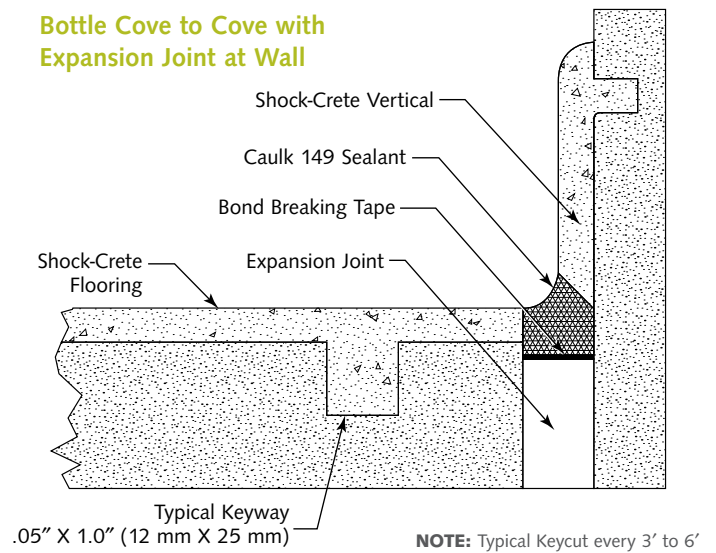

## Shock-Crete Tie-In to Block Wall

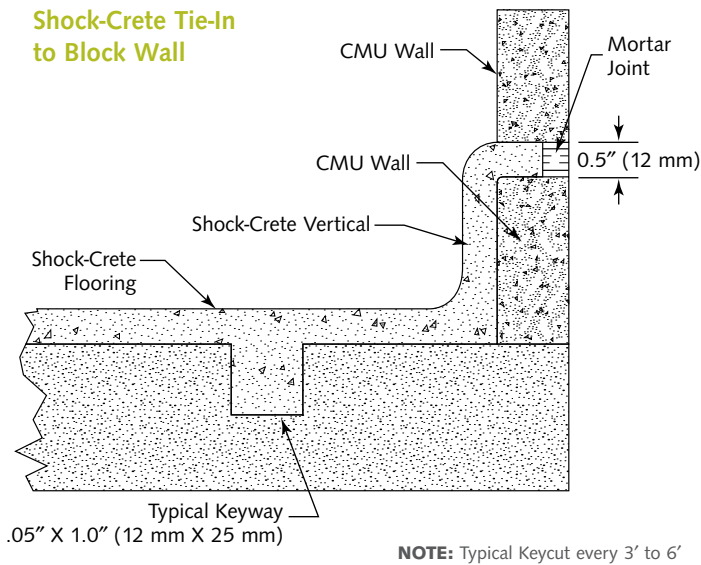

## Tie-In to Drywall

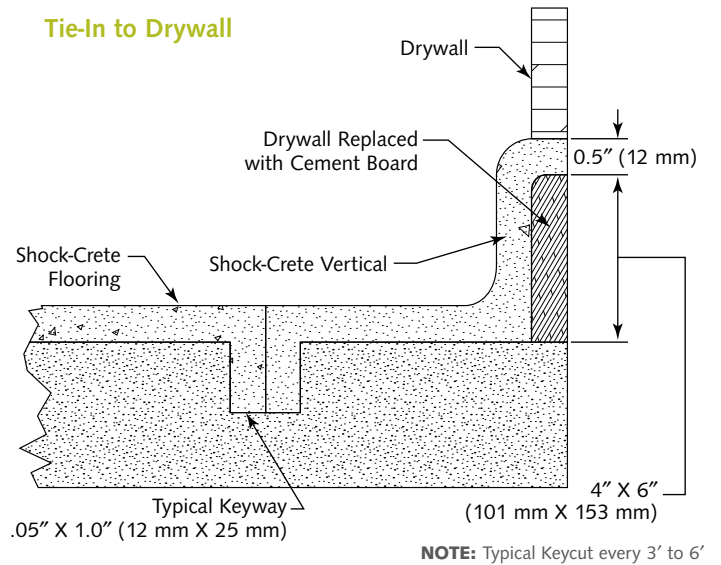

*High Performance Seamless  
Wall and Floor Systems*



1818 Miller Parkway  
Streetsboro, Ohio 44241  
1-800-322-1970  
330-562-1970  
Fax: 330-562-7638  
www.dudick.com  
email: sales@dudick.com

### **Our Commitment to You**

Service. Service. And more service.

That's the commitment of our Dudick team – and the secret to our success – for clients all over the world.

Our job isn't done until your job is completed, and you are totally satisfied. No excuses. No compromises. We're not satisfied until our customers are satisfied. Period.

Our products are state-of-the-art with exceptional durability. We have more than four decades of experience under our belt and more than 120 years of combined installation experience.

A 100% commitment to service and quality. This is our pledge to you.

*The Dudick Team*

