

LEADERSHIP IN TECHNOLOGY & SERVICE

Typical installation details

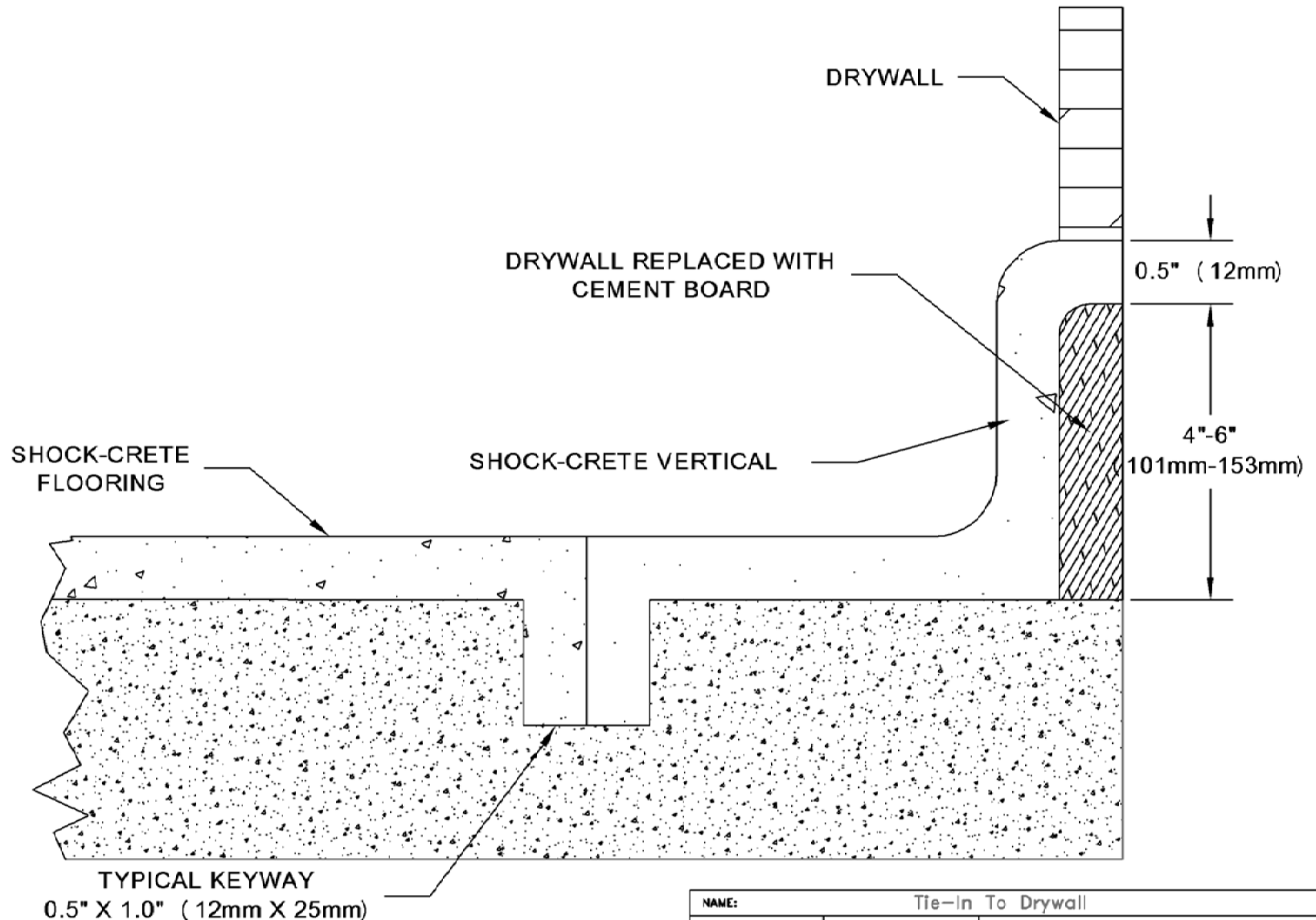

NOTE:
 TYPICAL KEYCUT EVERY 3' TO 6'

NAME:		Tie-In To Drywall	
DRWN. BY: JLM	DATE: 05/10/2012	DWG. NO. 8-1022	
APPD. BY:	DATE:	SCALE: NOT TO SCALE	SHEET: 1 OF 1